

# MNL

Marketing News Letter No. 2021-

## CHASE<sup>2</sup>HEPTA

### XNHU 09 Wiper Insert Design Upgrade

#### KEY POINT

TaeguTec's XNHU 09 milling wiper insert design has been upgraded.

Following the introduction of the CHASE-2-HEPTA's cutter pocket shape change (MNL 2020-06), TaeguTec has modified the design of the XNHU 09 wiper insert.

The insert is compatible with three cutter types; screw clamp, screw clamp with shim and wedge clamp.

Refer to the images below for the upgraded insert design.

The upgraded XNHU 09 wiper insert will be supplied after the current stock is phased out. For more information, please contact the product manager.

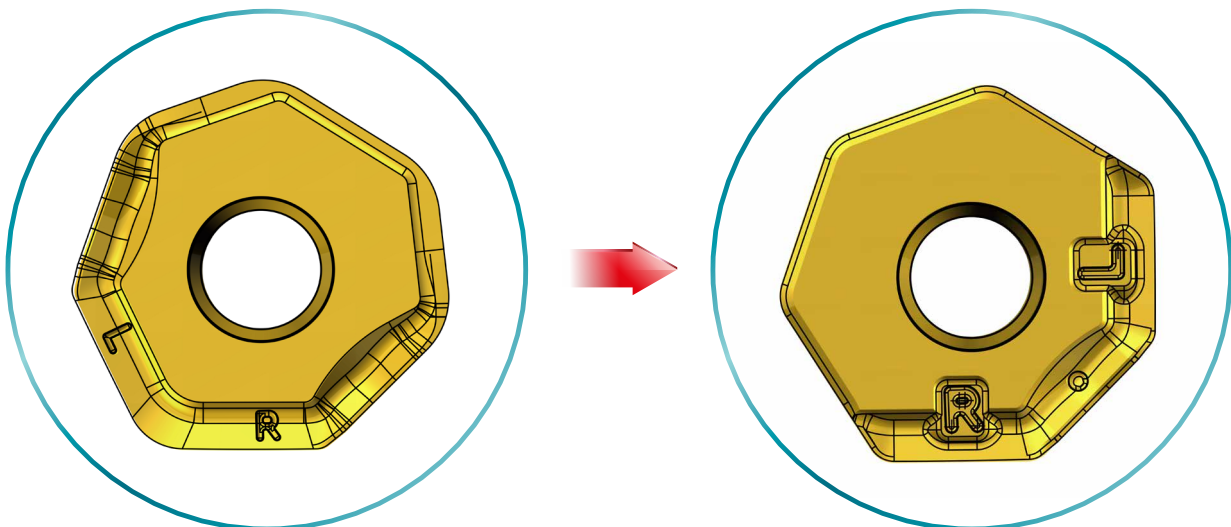

Sincerely,  
TaeguTec

**Cho-yeo-myeong**  
Rotating General PM

Sincerely,  
TaeguTec

**Choi-chul-won**  
Milling Product Manager

## Upgraded item

■ 5615750 XNHU 0906 ANTN-W TT6080

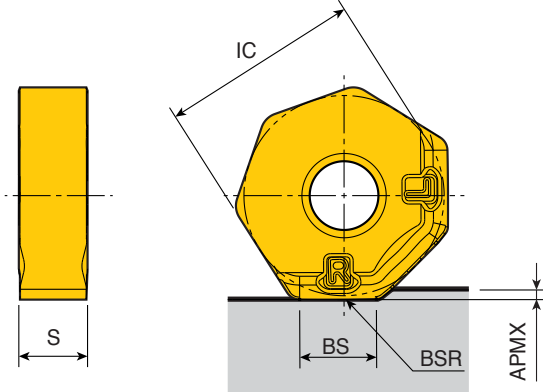

Dimensions(mm)				
IC	S	APMX	BS	BSR
18.5	6.35	1.0	7.1	250

## Upgraded insert illustrations when mounted to the cutter

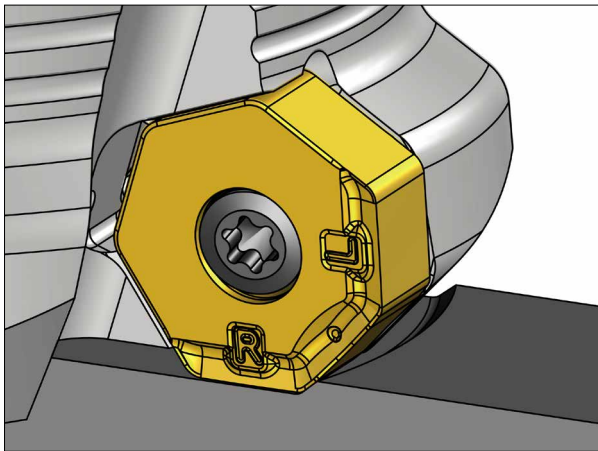

Right hand cutter

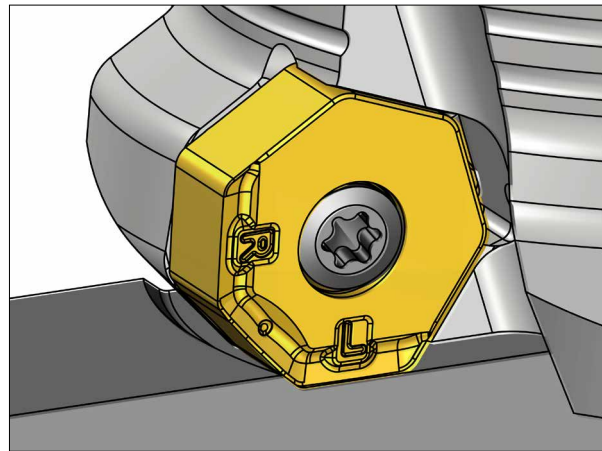

Left hand cutter

## Compatible cutters

Screw type	Screw type with shim	Wedge type
14D-F45XN...09	14D-F45XNH...09	14D-F45XNW...09 14D-F45XNW...09-QC